

NORTHERN NEVADA ARCHITECTURE .19

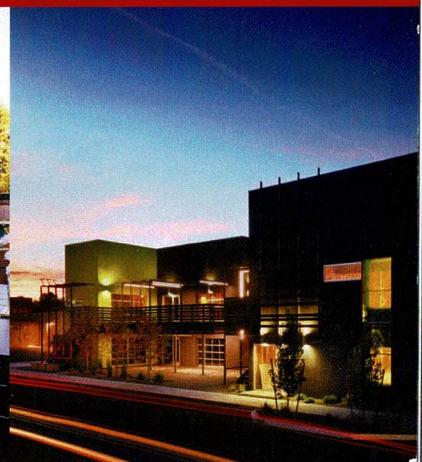

ANNUAL OFFICIAL PUBLICATION AND DIRECTORY OF AIA NORTHERN NEVADA





2019 AIA Northern Nevada Design Awards

design | strategy | vision



The American Institute of Architects, Northern Nevada is proud to present the winners of the 2019 AIANN Design Awards. There are three levels of achievement possible for award in each of the categories - Citation, Merit, and Honor. Honor being the highest design award AIANN can present to an architect or architectural firm.

Projects selected have set themselves apart from the typical in a positive way. Weighed individually and not in competition with each other, the general framework for review looked at the overall concept, the achievement of the program, and the way it had been executed. The jury also looked for exemplary traits in the following categories for final selection and determination of distinction level:

- **Societal advancement** - demonstrates a commitment to social progress.
- **Economic sensibility** - demonstrates achievement and commitment to good design with prudent economic resources.
- **Technical advancement** - demonstrates & explores new technologies and their architectural applications.
- **Preservation** - demonstrates skill, sensitivity, and thoughtfulness in preservation.
- **Adaptive reuse** - demonstrates alternative use of existing buildings regardless of their original architectural intentions.
- **Sustainability** - demonstrates a commitment to sustainable design. ♻️





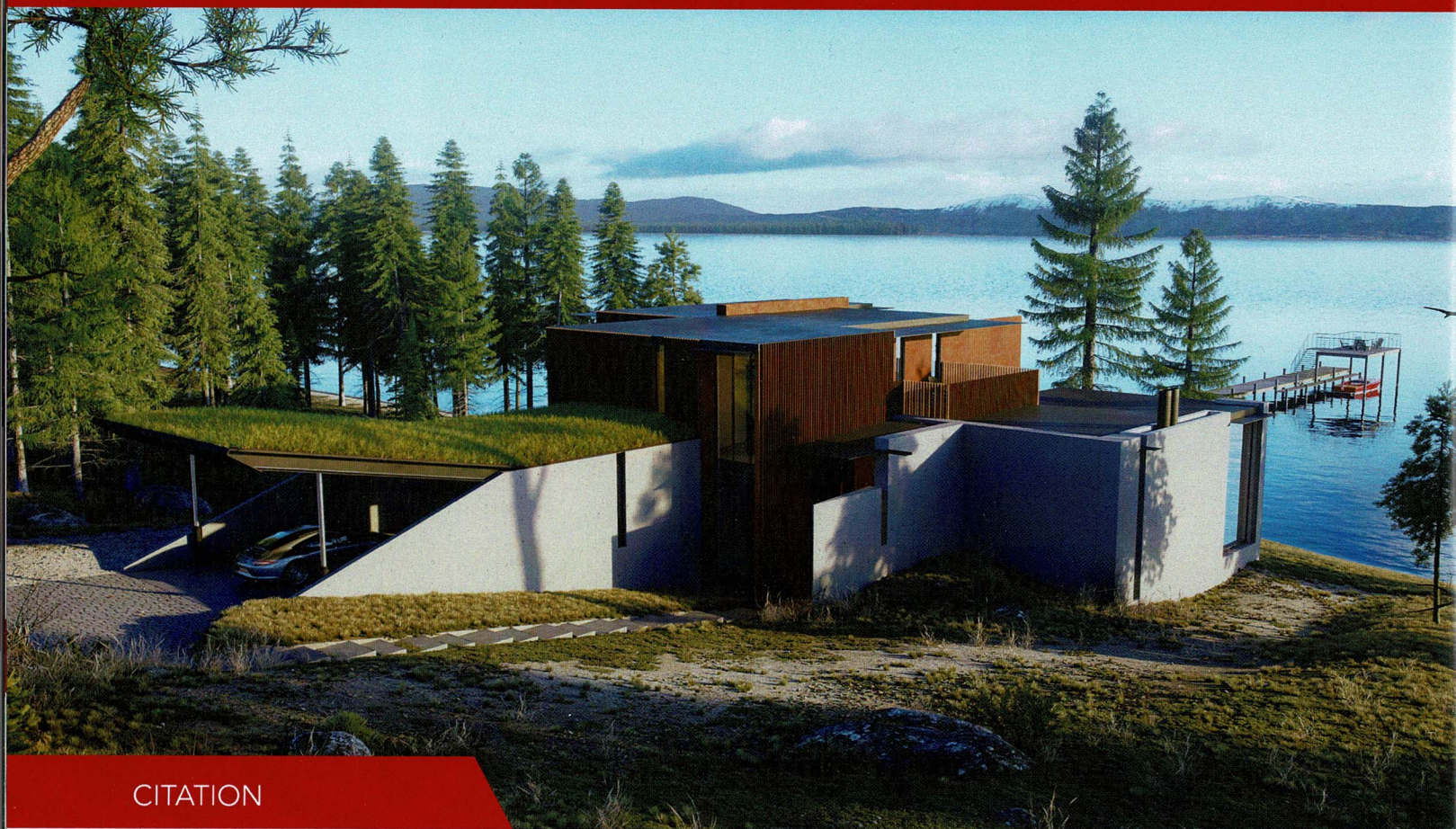

CITATION

Magnin architecture was approached by general contractor Andreas Rickenbach and realtor Michael Oliver to design two custom spec homes on lakefront property in Tahoma, Lake Tahoe. The site is accessed from a private driveway which leads to a forested parcel with a down-slope grade towards the lake and a north/northeast orientation with views of the lake. Directly to the southeast lies the boundary of Sugarpine Point State Park. The park will remain undeveloped.

The Lakefront home design (5,800 sf) was driven by the orientation of the site, the existing topography slope and views of the lake. The concept was to create a singular mass emerging out of the hillside that opens to a North/lake facing elevation of glass to optimize views. The home was designed with low reflectance glazing to help the project disappear into the upslope trees when viewed from the lake. From the sides, the home slips out of existing grade and gives a sense of being at one with the landscape and topography. This is reinforced by the driveway approach, which leads into a green roof garage hatch operated by a hydraulic lift that gives the appearance of the ground plane opening to accept vehicles into the home. The pedestrian entry flanks the side of the garage, where users enter a low profile portal consisting of a solid wood wall and door. Upon entering the home, the user is presented with an unobstructed 180 degree view of the lake. The lower level consists of all of the public program: living room, dining room and kitchen, plus the master suite with exterior bathing. The second floor includes

Architect: Magnin Architecture
Contractor: NA
Year Completed: 2019

three bedroom suites, two with elevated views of the lake/forest. Thin roof edges and expressions of structure, protection from the elements, and water movement inform the tectonics and detailing of the home.

The guest house (3300 sf) is on an upland forested portion of the lot, which is relatively flat. The plan for this home is a smaller and simpler design. The home uses the same material palette of corten steel and concrete for minimal maintenance, but since this home is off the lake, efforts were made to engage elevated forest views to Sugarpine. The lower level consists of the living, dining and kitchen areas, which open up to the ground plane and untouched forest to the southeast. The upper level consists of three bedrooms and a shared terrace. This terrace is elevated and oriented such that privacy is optimized for both homes, but also gives glimpses of the lake over home one and unobstructed views to the forest. ☺